

# Lighting

## Linear luminaire For fluorescent lamps

### GRP

6401/542-8008-15-131 Art. No. 256611



- Can be used in Ex Zones 2, 21 and 22
- Explosion-protected linear luminaire with two fluorescent lamps: 18 W, 36 W and 58 W
- Extremely robust: Impact strength rating of IK10

WebCode 6401A



The 6401 EXLUX luminaire is suited to normal indoor and outdoor lighting applications. In no time at all and with very little effort, using the accessories it can be fitted to the wall, ceiling or a pole, or alternatively, it can be suspended. The practical central lock is available with an optional switching element that disconnects the power supply at all poles when the plastic enclosure is opened. Light-weight yet strong: The high-quality workmanship makes this luminaire robust and minimises maintenance requirements.

## Technical Data

### Explosion Protection

Application range (zones)	2 21 22
IECEX gas certificate	IECEX PTB 14.0035
ATEX gas certificate	PTB 14 ATEX 2017
IECEX dust certificate	IECEX PTB 14.0035
ATEX dust certificate	PTB 14 ATEX 2016
Ambient temperature °C	-30 ... +55 °C
Gas explosion protection IECEX	Ex nA IIC T4 Gc
Gas explosion protection ATEX	⊕ II 3 G Ex nA IIC T4 Gc
Dust explosion protection IECEX	Ex tb IIIC T80 °C Db
Dust explosion protection ATEX	⊕ II 2 D Ex tb IIIC T80 °C Db
Dust explosion protection IECEX 2	Ex tc IIIC TT80 °C Dc
Dust Explosion Protection ATEX 2	⊕ II 3 D Ex tc IIIC TT80 °C Dc
Certificates	ATEX (PTB), IECEX (PTB)
Ship approval	DNVGL
Languages of the documentation	English German

### Electrical Data

Ex version	Yes
Rated operational voltage AC	220 – 240 V
Rated operational voltage AC	220 – 240 V
Rated operational voltage DC	220 – 240 V
Frequency range	50 – 60 Hz
Lamp wattage	36 W

# Lighting

Linear luminaire For fluorescent lamps

GRP

6401/542-8008-15-131 Art. No. 256611



## Lighting Data

Number of Lamps	2
Lamp wattage	36 W
Lamp	G13 lamp base
Luminaire efficacy	0 lm/W
Luminous flux	0 lm
Colour temperature	0 K

## Ambient Conditions

Ambient temperature °F	-999 - -999 °F
Ambient temperature min.	-30 °C
Ambient temperature max.	+55 °C
Ambient temperature	-30 °C ... +55 °C

## Mechanical Data

Version	Standard
Degree of Protection IP (IEC 60598)	IP66/IP67
Protection class	I (with inner PE connection)
Enclosure material	Polyester resin, Glass fibre reinforced
Sealing material	Silicone
Material translucent cover	Polycarbonate
Installed terminal strip	PE + N + L1 + L2 + L3
Connection terminals solid max.	4 mm <sup>2</sup>
Connection terminals finely-stranded max.	4 mm <sup>2</sup>
Type of connection cable	Stranded Solid Finely stranded
Design size	4
Width	184 mm
Height	125 mm
Length	1310 mm
Impact strength (IK code)	IK10 (IEC 62262)
Enclosure colour	Light grey (RAL 7035)
Weight	5.3 kg

## Components

Threaded plate	2x plastic
Ballast	ELXe
Through wiring	Without
Drilled holes	3 x M25
Screw connections	2 x M25 Ø 7 – 17 mm
Material of cable entry	Polyamide, black
Stopping plug	2 x M25 x 1.5
Stopping plug material	Polyamide, black

# Lighting

Linear luminaire For fluorescent lamps

GRP

6401/542-8008-15-131 Art. No. 256611



Dimensional Drawings (All Dimensions in mm [inches]) – Subject to Alterations

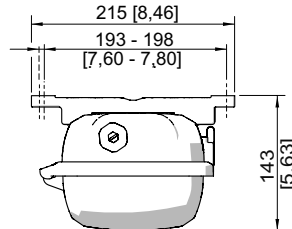
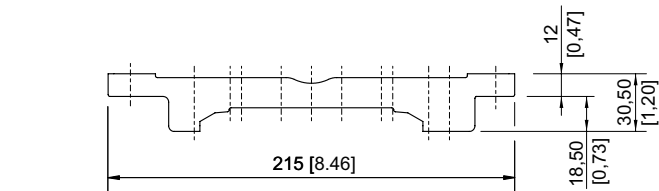

Mounting rail

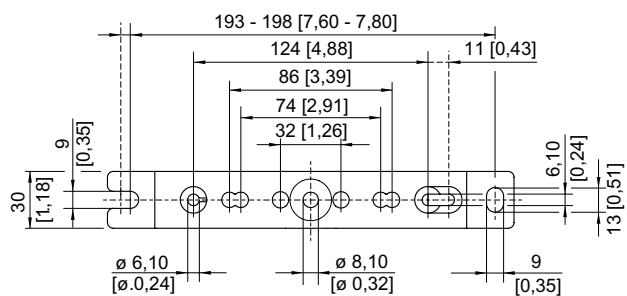

Mounting rail

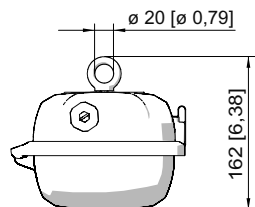

Ring bolt fitted in insert nut of the luminaire

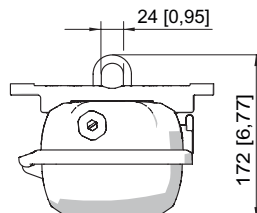

Mounting bracket fitted in mounting rail

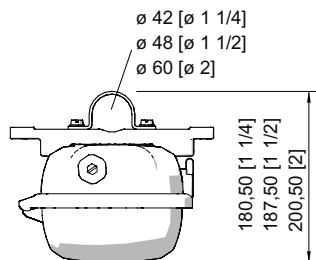

Pipe clamp fitted in mounting rail

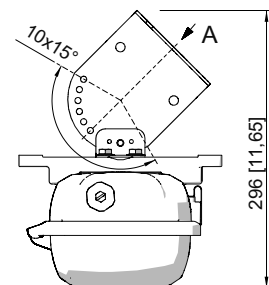

A

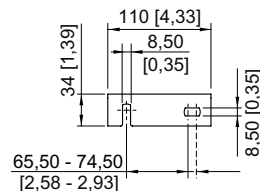

Wall mounting bracket fitted in mounting rail

# Lighting

Linear luminaire For fluorescent lamps

GRP

6401/542-8008-15-131 Art. No. 256611

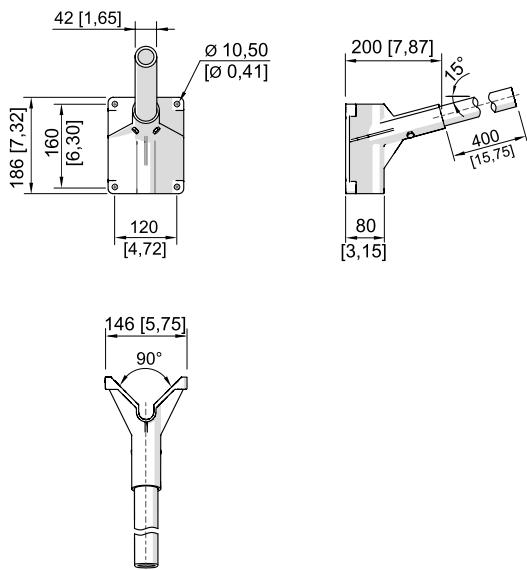

Bracket for wall mounting with pipe section

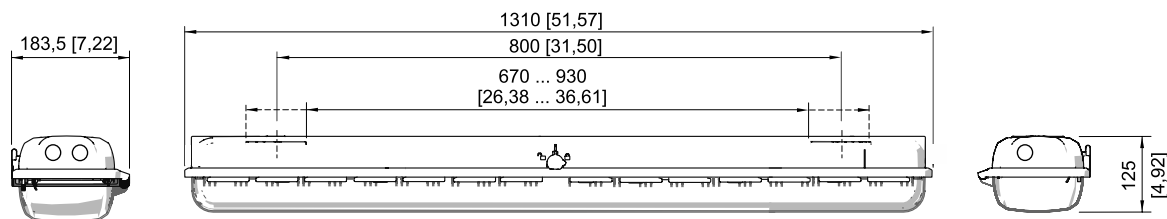

Size 4

## Accessories and Spare Parts

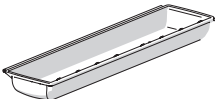
Cover		Art. No.
	for luminaire size 4 (resistant to aromatic substances)	256535

We reserve the right to make alterations to the technical data, dimensions, weights, designs and products available without notice. The illustrations cannot be considered binding.